

# TECHNICAL DATASHEET



## REDUCED TEE 90°

03 Update - 05/2024

### TECHNICAL DATA

|                        |                   |
|------------------------|-------------------|
| Article No             | 001 117 0042 0202 |
| d1<br>(mm)             | 200               |
| d2<br>(mm)             | 160               |
| L<br>(mm)              | 481               |
| le1<br>(mm)            | 117               |
| le2<br>(mm)            | 103               |
| Z<br>(mm)              | 227               |
| s1<br>(mm)             | 18,2              |
| s2<br>(mm)             | 14,6              |
| Weight<br>(Kg)         | 6,900             |
| Box Quantity<br>(pcs)  | 3                 |
| Box Dimension<br>(pcs) | 36x60x52,5        |

### IDENTIFICATION OF PRODUCT

|                |   |
|----------------|---|
| D(mm)          | 200-160                                 |
| SDR            | 11                                      |
| RAW METARIAL   | PE 100                                  |
| PRESSURE CLASS | 16 Bar Water 10 Bar Gas                 |
| TRADEMARK      | NTG                                     |
| EXECUTION      | Injection Moulded                       |
| STANDARD       | EN 12201-3<br>EN 1555-3<br>AS /NZS 4129 |

### INJECTION MOULDED

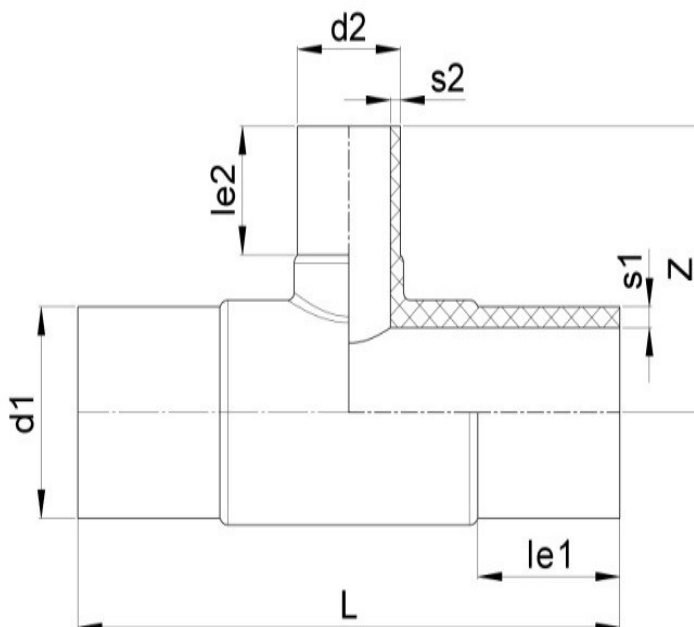

### SPECIFICATION

Long Spigot

Tolerance on diameters and thickness according to the standards. The other dimensions are specialized. Tolerance  $\pm 5\%$ . NTG PLASTIK reserves all the right to change any information without giving prior notice. The production, distribution and utilization of this document without explicit authorization is prohibited.